

Bearing No. SAF 23056K 10/1/2

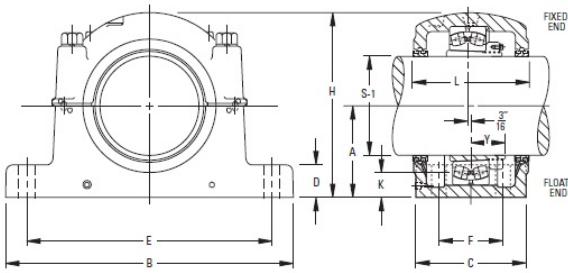

| | |
|---------------------------|------------------|
| Weight | 26.2500 in |
| Bearing Number | ER 710 |
| Housing Construction | Triple Ring Seal |
| UPC Code | SAF056K-10 1/2 |
| Shaft Size Type | 20.1875 in |
| Full Timken Part Number | SAF23056K10-1/2 |
| Locking Style | 5.5 in |
| Y2 - Geometry Factor | 29.5000 in |
| Y1 - Geometry Factor | 10 1/2 in |
| Shaft Tolerance | 4.0000 in |
| Shaft Size | 9.000 in |
| Pre Install Clearance Min | 4 |
| Pre Install Clearance Max | 1.5 in |