

Bearing No. SDAF 23156K 10/1/2

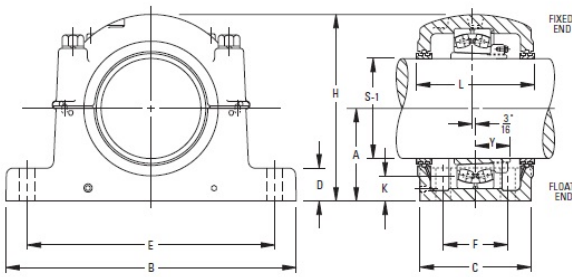

Weight	32.7500 in
Bearing Number	ER 710-1
Housing Construction	A8967
UPC Code	SDAF3156K x 10-1/2
Shaft Size Type	23.4375 in
Full Timken Part Number	SDAF23156K10-1/2
Locking Style	9 in
Y2 - Geometry Factor	33.5000 in
Y1 - Geometry Factor	33.1250 in
Shaft Tolerance	10 1/2 in
Shaft Size	3.3750 in
Pre Install Clearance Min	14.7500 in
Pre Install Clearance Max	1.625 in