

Bearing No. RE162020AL2

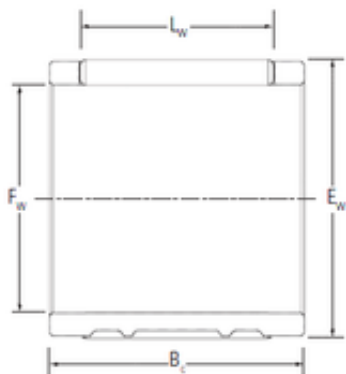

Fw	16 mm
Ew	20 mm
Bc	19.5 mm
Lw	13.8 mm
Weight	0.013 Kg
Bearing number	RE162020AL2
Bore Diameter (mm)	16
Outer Diameter (mm)	20
Basic dynamic load rating (C)	9.95 kN