

Bearing No. RCJ1-15/16

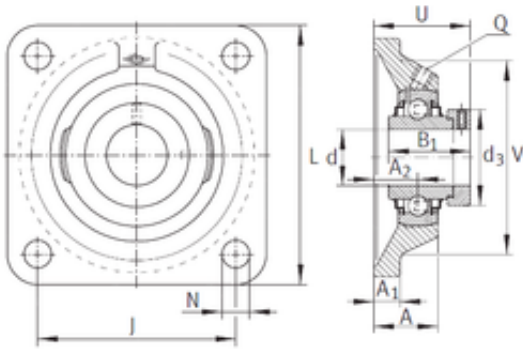

d	49,213 mm
V	126,009 mm
U	66,192 mm
A	42,012 mm
B	62,789 mm
J	110,998 mm
L	143,002 mm
N	16,993 mm
d3	69,012 mm
A1	15,011 mm
A2	27,991 mm
Thread (Q)	1/8 NPT
Bearing number	RCJ1-15/16
Bore Diameter (mm)	49,213